

# AUBO-i10

## i SERIES

### COLLABORATIVE ROBOT



 **10KG**  
Payload

 **38.5KG**  
Weight

 **±0.03mm**  
Repeatability

 **1350mm**  
Reach

- ✓ The AUBO-i10 collaborative robot has a maximum working radius of 1350mm,
- ✓ A payload capacity of 10kg, and boasts a repeat positioning accuracy of ±0.03mm.
- ✓ It offers a high payload and a long working radius.

#### Application Fields

3C electronics, automotive, new energy, semiconductors, mechanical processing, hardware home appliances, kitchen and bathroom sanitary ware, medical health, scientific research and education, catering, new retail, daily chemicals, logistics.

#### Product Advantages

- 01 **More Accurate Positioning** The repeatability and power-on positioning accuracy have been further improved, the maximum collision force value has been reduced, and millisecond-level system response speed ensures accurate positioning, resulting in a smoother operation trajectory.
- 02 **Faster Speed** Working speed has been increased by 10%-20%. The 6-axis robotic arm operates efficiently, which significantly improves work efficiency.
- 03 **Stronger Functionality** An open system platform with integrated 485 communication at the end of the arm has been adopted, and functions such as end-of-arm tool drag-and-drop teaching are added. It supports high-current power supply and can directly establish communication with a wider variety of end effectors, vision systems, mobile and other peripheral equipment, making the system more flexible and convenient.
- 04 **Superior Safety** The product has passed multiple professional certifications, is stable and reliable, with improved collision detection sensitivity, and does not require safety barriers, making human-robot collaboration safer.



High Performance



High Precision



Rapid Response



Safe and Stable



Modular Design



Flexible Production



Fine Workmanship



High Protection Level



Compact and Portable

Others

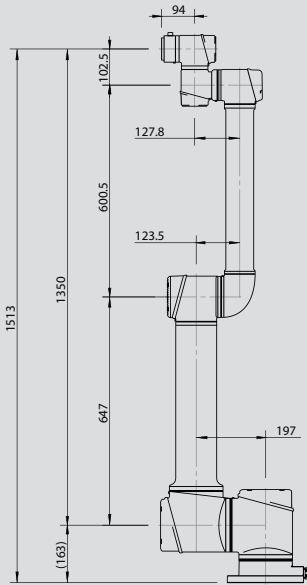

AUBO-i10 Dimensions

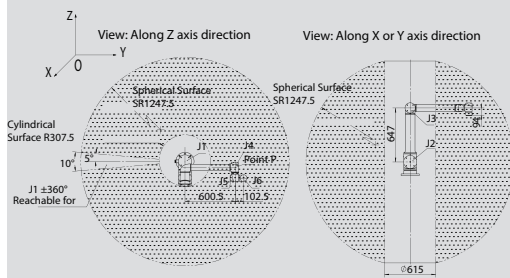

AUBO-i10 Moving Range of Point P

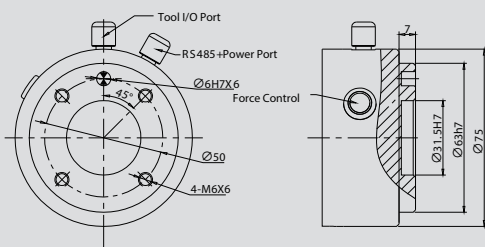

AUBO-i10 Tool End Flange

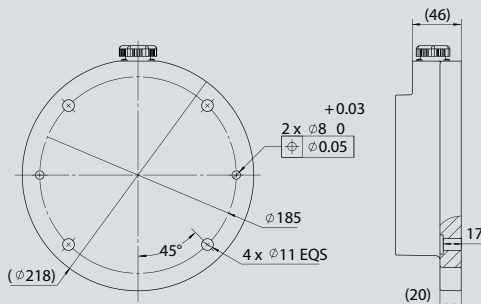

AUBO-i10 Top View of Base

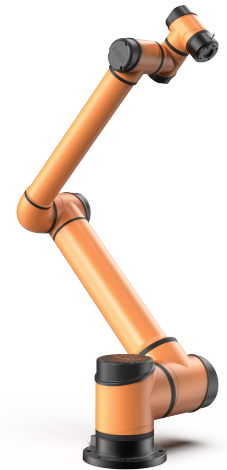

### Robot

|                                |                          |
|--------------------------------|--------------------------|
| Degrees of Freedom             | 6                        |
| Reach (mm)                     | 1350                     |
| Payload (kg)                   | 10                       |
| Weight (kg)                    | 38.5                     |
| Mounting Surface Diameter (mm) | Ø220                     |
| Repeatability (mm)             | ±0.03                    |
| Linear Velocity (m/s)          | ≤4.0                     |
| Average Power(W)               | 500                      |
| Peak Power (W)                 | 2000                     |
| Ambient Temperature (°C)       | 0-50                     |
| Ambient Humidity               | 90%RH (Non-condensing)   |
| Installation Orientation       | Any ceiling, Floor, Wall |
| IP Classification              | IP54                     |
| ISO 14644-1 Cleanliness Class  | 5                        |

### Axis Movement

|         | Working Range (°) | Maximum Speed (°/s) |
|---------|-------------------|---------------------|
| joint 1 | ±360              | 178                 |
| joint 2 | ±360              | 178                 |
| joint 3 | ±167              | 223                 |
| joint 4 | ±360              | 237                 |
| joint 5 | ±360              | 237                 |
| joint 6 | ±360              | 237                 |

\*Each joint has the ability of ±360°, but limited by the application scenario, part of the joints may not be reached.

### Control Box

|                          |  |
|--------------------------|--|
| Model                    | AUBO-CB-M  |
| Size (L*W*H)             | 380mm*350mm*265mm                                  |
| Weight                   | 15 kg  |
| Cable Connecting Robot   | 5 m (customizable, up to 8m)                       |
| Cable Connecting Pendant | 4m   |
| Cable Connecting Power   | 5m   |
| Communication            | Ethernet, ModBus-RTU/TCP, Profinet (optional)      |
| Interface                | SDK(support C/C++/C#/Lua/Python), support ROS, API |
| Power Supply             | 100-240VAC,50-60Hz                                 |
| IP Classification        | IP43   |



### Control Box I/O, Tool I/O

|           | Control Box    | Tool                    |
|-----------|----------------|-------------------------|
| I/O Port  | Digital In     | 16 (general) /16 (safe) |
|           | Digital Out    | 16 (general) /16 (safe) |
|           | Analog In      | 4                       |
|           | Analog Out     | 4                       |
| I/O Power | Output Voltage | 24V                     |
|           | Output Current | 3A max                  |
|           |                | 4(optional)             |
|           |                | 4(optional)             |
|           |                | 2                       |
|           |                | -                       |
|           |                | 0V/12V/24V              |
|           |                | 0.8A                    |

### Teach Pendant

|                   |  |
|-------------------|--|
| Model             | AUBO-TP                                  |
| Dimensions        | 322*236*45.2mm (Excluding E-Stop Button) |
| Weight            | 2.56kg (Including Cable)                 |
| IP Classification | IP43                                     |
| Colors            | Orange + black                           |



### Disclaimer

1. The content of this product catalog is subject to change without prior notice.  
 2. This product catalog is an original work of our company and all copyrights belong to us. Please cite the source when reprinting or quoting content from this catalog. Unauthorized reproduction is prohibited and will be considered an infringement, for which legal liability will be pursued according to law.